

| | | | |
|---|---------------------------|----------------------------|--|
| © FREESCALE SEMICONDUCTOR, INC. ALL RIGHTS RESERVED. | MECHANICAL OUTLINE | PRINT VERSION NOT TO SCALE | |
| TITLE: TO-270 WIDE BODY 14 LEAD GULL WING | DOCUMENT NO: 98ASA10653D | REV: A | |
| | CASE NUMBER: 1621-02 | 19 JUN 2007 | |
| | STANDARD: NON-JEDEC | | |

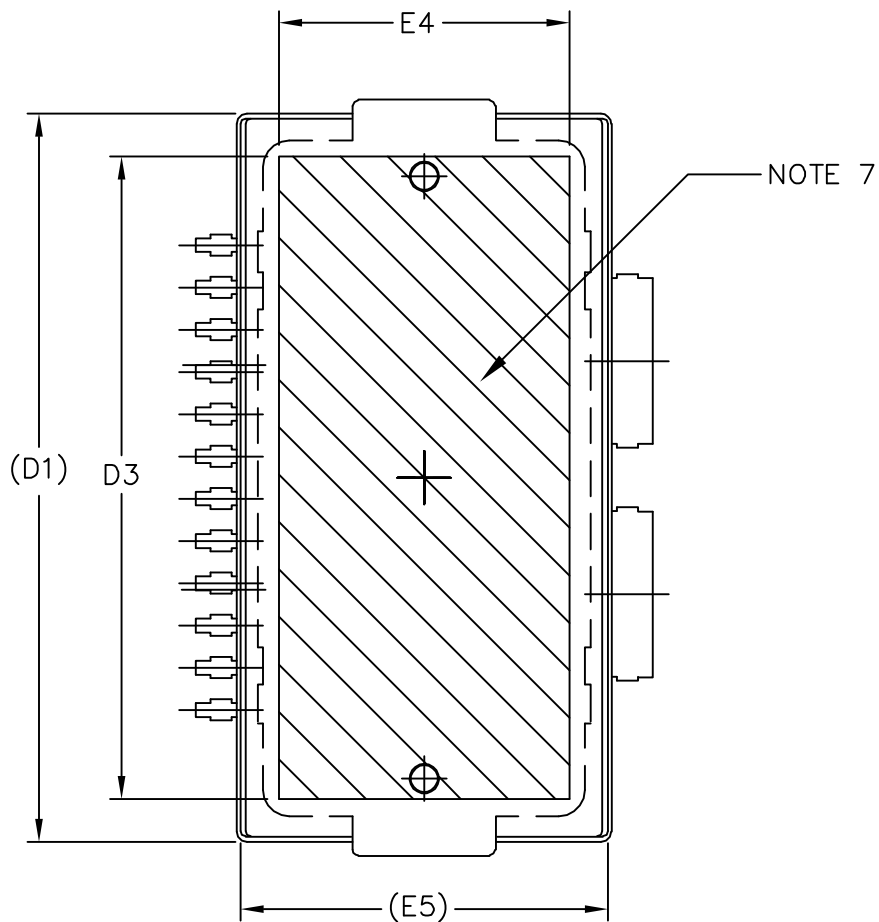

VIEW Y-Y

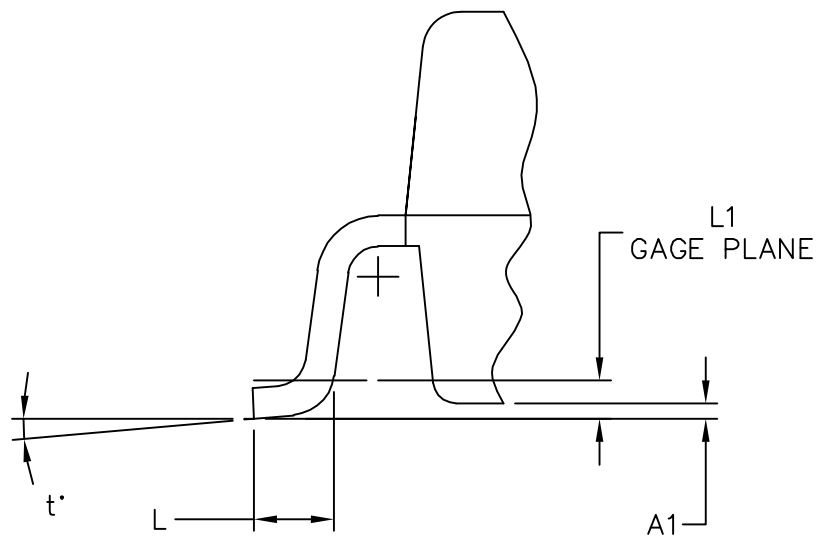

DETAIL "Y"

| | | | |
|---|---------------------------|----------------------------|--|
| © FREESCALE SEMICONDUCTOR, INC. ALL RIGHTS RESERVED. | MECHANICAL OUTLINE | PRINT VERSION NOT TO SCALE | |
| TITLE: TO-270 WIDE BODY 14 LEAD GULL WING | DOCUMENT NO: 98ASA10653D | REV: A | |
| | CASE NUMBER: 1621-02 | 19 JUN 2007 | |
| | STANDARD: NON-JEDEC | | |

NOTES:

1. CONTROLLING DIMENSION: INCH
2. INTERPRET DIMENSIONS AND TOLERANCES PER ASME Y14.5M-1994.
3. DATUM PLANE -H- IS LOCATED AT THE TOP OF LEAD AND IS COINCIDENT WITH THE LEAD WHERE THE LEAD EXITS THE PLASTIC BODY AT THE TOP OF THE PARTING LINE.
4. DIMENSIONS "D" AND "E1" DO NOT INCLUDE MOLD PROTRUSION. ALLOWABLE PROTRUSION IS .006 PER SIDE. DIMENSIONS "D" AND "E1" DO INCLUDE MOLD MISMATCH AND ARE DETERMINED AT DATUM PLANE -H-.
5. DIMENSIONS "b" AND "b1" DOES NOT INCLUDE DAMBAR PROTRUSION. ALLOWABLE DAMBAR PROTRUSION SHALL BE .005 TOTAL IN EXCESS OF THE "b" AND "b1" DIMENSION AT MAXIMUM MATERIAL CONDITION.
6. DATUMS -A- AND -B- TO BE DETERMINED AT DATUM PLANE -H-.
7. HATCHING REPRESENTS THE EXPOSED AREA OF THE HEAT SLUG.

| DIM | INCH | | MILLIMETER | | DIM | INCH | | MILLIMETER | |
|-----|------|------|------------|-------|-----|-----------|------|------------|------|
| | MIN | MAX | MIN | MAX | | MIN | MAX | MIN | MAX |
| A | .100 | .104 | 2.54 | 2.64 | L | .018 | .024 | 0.46 | 0.61 |
| A1 | .001 | .004 | 0.02 | 0.10 | L1 | .010 BSC | | 0.25 BSC | |
| A2 | .099 | .110 | 2.51 | 2.79 | b | .154 | .160 | 3.91 | 4.06 |
| D | .712 | .720 | 18.08 | 18.29 | b1 | .010 | .016 | 0.25 | 0.41 |
| D1 | .688 | .692 | 17.48 | 17.58 | c1 | .007 | .011 | .18 | .28 |
| D2 | .011 | .019 | 0.28 | 0.48 | e | .020 BSC | | 0.51 BSC | |
| D3 | .600 | --- | 15.24 | --- | e1 | .040 BSC | | 1.02 BSC | |
| E | .429 | .437 | 10.9 | 11.1 | e2 | .1105 BSC | | 2.807 BSC | |
| E1 | .353 | .357 | 8.97 | 9.07 | t | 2' | 8' | 2' | 8' |
| E2 | .132 | .140 | 3.35 | 3.56 | | | | | |
| E3 | .124 | .132 | 3.15 | 3.35 | aaa | .004 | | .10 | |
| E4 | .270 | --- | 6.86 | --- | | | | | |
| E5 | .346 | .350 | 8.79 | 8.89 | | | | | |

© FREESCALE SEMICONDUCTOR, INC.
ALL RIGHTS RESERVED.

MECHANICAL OUTLINE

PRINT VERSION NOT TO SCALE

TITLE: TO-270 WIDE BODY
14 LEAD
GULL WING

DOCUMENT NO: 98ASA10653D

REV: A

CASE NUMBER: 1621-02

19 JUN 2007

STANDARD: NON-JEDEC