

PROPRIETARY DATA
 This document may not be reproduced, disclosed, or otherwise used, in whole or in part, without the written permission of SIRENZA MICRODEVICES

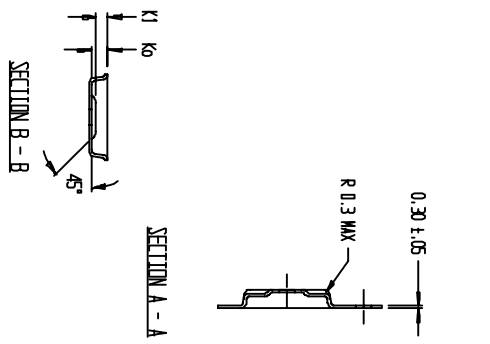

Advantek: TSSP20.AC.99.0P2

- NOTES:
1. 10 SPRING HOLE PITCH DIMLATIVE TOLERANCE ±0.2
 2. CENTER IN DIMLINE WITH EA 481
 3. PCKET POSITION RELATIVE TO SPRING HOLE REQUIRED AS THE POSITION OF PCKET, NOT PCKET HLE

A0 = 6.95
 A0 = 7.10
 K0 = 1.80
 K1 = 1.20

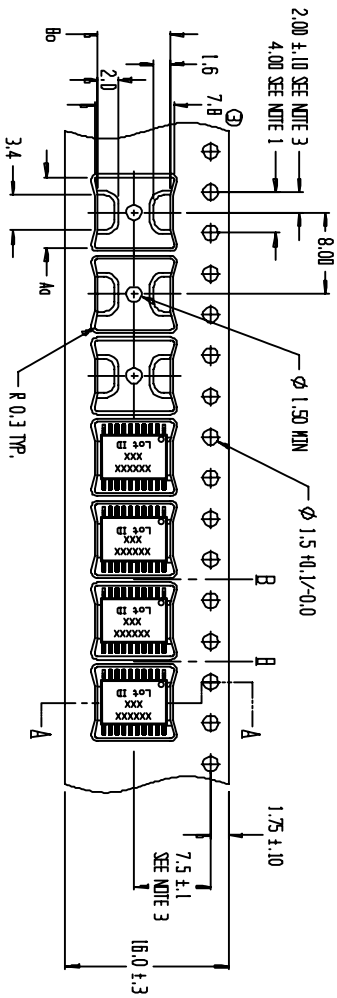

REVISION HISTORY				
ZN/REV	DESCRIPTION	ECD	APPR	DATE
A	Eng Rel	7036	Barcome	10/18/06

THIRD ANGLE PROJECTION	UNLESS OTHERWISE SPECIFIED, DIMENSIONS ARE IN MILLIMETERS PER DECIMAL ANGLES ARE ±1/2°
XXX00X NEXT ASSY VARIATION USED	XXX00X MODEL
See Notes	See Notes
FINISH	See Notes

DO NOT SCALE DRAWING	SIGNATURE	DATE
DWG PATH/FILENAME		

SIRENZA MICRODEVICES

DWG TITLE: TSSP20 Tape and Reel Dwg

SIZE DWG NO. MPD-105578

REV A

SHEET 1 OF 1