

FORK-LIFT STUD-MOUNTED FUSES

48 or 80 Volts DC • Fast-Acting and Time-Delay • 35-800 Amperes



CNN Limiter Fuses



Description

CNN/E fuses are rated for applications up to 80 VDC. As fork lift trucks and electrical vehicle system voltages increase, circuit protection needs to be rated higher than the standard CNN products to handle the increased voltage. The CNN/E is considered very fast-acting for quicker reaction time.

Specifications

Voltage Ratings: 48-80 VDC
Max. Interrupting Rating: 2,500 A
Ampere Ratings: 35 – 800 A
Approval: UL Recognized (File No. E71611)

Features/Benefits

- 80 VDC Protection
- Window shows fuse status
- 2,500 A interrupting rating
- Compact size saves space
- RoHS compliant and lead free

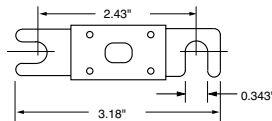

Ordering Information

AMPERE RATINGS CNN/E					
35	80	150	250	350	700*
40	90	175	275	400	800*
50	100	200	300	500	—
60	125	225	325	600	—

*Contact factory for availability

SERIES	AMP	VOLT	CATALOG NUMBER	SYSTEM NUMBER	TYPE
CNN/E	200	80	CNN200E	0CNN200E.V	FAST-ACTING
CNN	200	48	CNN200	0CNN200.V	FAST-ACTING
CNL	200	48	CNL200	0CNL200.V	TIME-DELAY

48 VDC products are available in time-delay and fast-acting. See Web for details. Contact factory for 48V and time-delay products.

Recommended Fuseholders

LFFB0003Zpg. 116

Web Resources

80 V: www.littelfuse.com/cnne
 48 V: www.littelfuse.com/cnn